

Model 750 – Type A

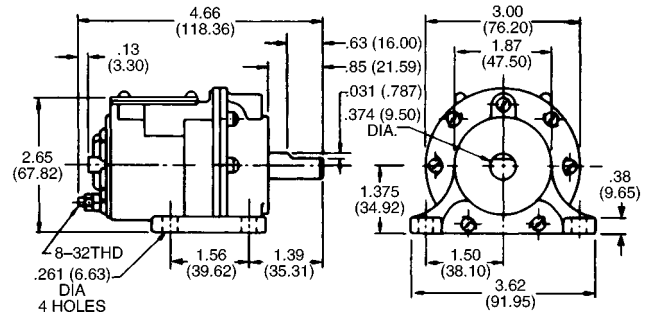

DIMENSIONS
INCHES
(MILLIMETERS)

Base Mounting

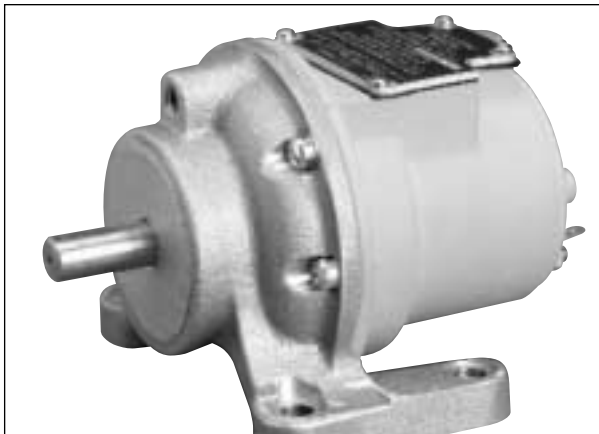

Binding Post Cover Box

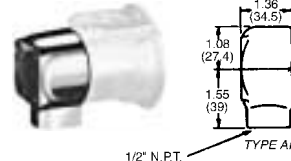

The Model 750 DC Tachometer-Generator embodies a permanent magnet field surrounding a rotating armature. The commutator segments are made from a special non-corrosive alloy which has an exceptionally long life. The brushes are of a self-lubricating material and are carried in a self-aligning holder which equalizes the pressure of both brushes. The armature shaft rotates on ball bearings which under normal operation do not need lubrication for 15,000 hours running time or approximately 3 years, whichever comes first. Maximum recommended speed is 5,000 rpm. Brush life is greatest at the lower speeds.

Rigid, die-cast, dust-proof aluminum housing and mounting base. 3/8" diameter shaft extension for direct coupling drive, pulley, spur gear, or chain and sprocket. Two binding posts for electrical connection.

Approximate torque: 1.0 oz.-in. starting, 1.0 oz.-in. running (1000 RPM).
Approximate weight: 1.7 lbs. (.77 kg). **Cat. No.750-9901000**

Binding Post Cover Box

Provides protection for the terminals, and has a 1/2" NPT connection for conduit. **Cat. No.9933-0143156**

Replacement Brush Kit

Metallic leaf brushes are of an alloy which will wear before the commutator bars. Brush replacement is a simple field operation. **Part No. 249302.901**

SPECIFICATIONS

VOLTAGE OUTPUT AT 1000 RPM

6 Volts ±1% Per 1000 RPM

ACCURACY:

±1%

EMF LINEARITY 1:

±0.15%

PERMISSIBLE CURRENT DRAIN:

50 mA

MAX RMS VALUE OF AC RIPPLE:

2%

ALLOWABLE END PLAY:

.005"

MAX OPERATING TEMPERATURE:

250°F

INTERNAL RESISTANCE AT 25°C:

20 Ω ±2%

NUMBER OF BRUSHES:

2 Per Set

COMPOSITION OF BRUSHES:

Palladium Silver Alloy

ARMATURE:

12 Bars, 12 Slots

INSULATION:

Insulation Class 105

HI-POT TEST:

500 Volts for 1 Min.

BEARINGS:

Ball

TEMPERATURE COMPENSATION:

0.1% Per 10°C Change

NORMAL CONTINUOUS SPEED:

2000 RPM

MIN TOP SPEED:

100 RPM

MAX SPEED 2:

5000 RPM

STARTING TORQUE:

1.0 oz. ins.

RUNNING TORQUE:

1.0 oz. ins.

WEIGHT:

1.7 lbs.

LENGTH:

4.66"

HEIGHT:

2.87"

WIDTH:

3"

MOUNTING:

Base

ENCLOSURE:

Dust Resistant

SHAFT DIAMETER:

3/8"

SHAFT CONNECTION:

Direct, Geared or Belted

SHAFT LENGTH:

.85" (w/.63 Flat)

ADJUSTABLE MAGNETIC SHUNT RANGE:

±4%

DIRECTION OF ROTATION EFFECT:

±0.6%