

Model 758 – Type JB2



Screw Mounting



DIMENSIONS INCHES (MILLIMETERS)

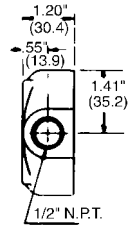
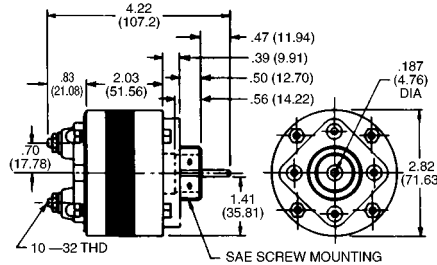

**Binding Post
Cover Box**

The 758 Series of tachometers all use a multi-pole cylindrical magnet turning in a wound stator constructed from quality transformer iron lamination. Single phase output current is a sine wave over the speed range of the tachometer. These units have 100 ohm stators and are intended for voltage responsive systems. When greater accuracy is required, use a tachometer having a 32 ohm stator (designation F in the type number) and a frequency responsive indicating system. For speeds over 5,000 rpm, use the bearingless AC generators on page 446.

Dust-proof aluminum alloy housing. S.A.E. 7/8" screw-type steel mounting with 3/16" solid drive dog. Used on Diesel and gas engines where a standard S.A.E. screw-type tachometer outlet is available. Two binding posts for electrical connection.

Approximate torque: 2.0 oz.-in. starting, 2.0 oz.-in. running (1000 RPM).

Approximate weight: 2.5 lbs. (113 kg.).

Type JB2—for Voltage-Responsive Systems,
Cat. No.758-9905000.

Type JBF2 for Frequency-Responsive Systems.
Cat. No.0133477-902.

Type JB5—Same as Type JB2, but binding posts are replaced by a cover box and an AND 10066-12S-3P connector.

Mating socket connector is AN3106-12S-3S (not supplied).

Type JB5—for Voltage-Responsive Systems.
Cat. No.758-9905001

Type JBF5—for Frequency-Responsive Systems.
Cat. No.0134030-901.

SPECIFICATIONS

VOLTAGE OUTPUT AT 1000 RPM: 10 Volts AC $\pm 1\%$ Per 1000 RPM Open Circuit

PERMISSIBLE CURRENT DRAIN: 150 mA

FREQUENCY AT 900 RPM: 60 Hz Sine Wave

ALLOWABLE END PLAY: .005"

MAX. OPERATING TEMPERATURE: 250°F

INTERNAL RESISTANCE AT 25°C
Standard Unit: 100 Ω $\pm 1\%$
F. Type Unit*: 32 Ω $\pm 20\%$

STATOR: 8 Poles

INSULATION: Insulation Class 105

ROTOR: Alnico V, 8 Poles

BEARINGS: Ball

ACCURACY: $\pm 1\%$

Temperature Coefficient
Standard Unit: 0.2% Per 10°C Change
F. Type Unit*: Not Compensated, 0.4% Per 10°C Change

EMF LINEARITY: Dependent Upon Load and Speed

MIN. SPEED: 500 RPM

MAX. TOP SPEED: 5000 RPM

STARTING TORQUE: 2-3 oz. ins.

RUNNING TORQUE AT 1000 RPM: 2-3 oz. ins.

WEIGHT: JB2-2.9 lbs. JB5-2.6 lbs.

LENGTH: JB2-4.22" JB5-4.59"

WIDTH: 2.82"

HEIGHT: JB2-2.82" JB5-3.38"

MOUNTING: SAE 7/8" Screw

ENCLOSURE: Dust Resistant

SHAFT DIAMETER: 3/16"

SHAFT CONNECTION: Direct

SHAFT LENGTH: .47"

ELECTRICAL CONNECTION: JB2-10-32 Studs
JB5-AN Plug Connection

*F-Type generators for use in frequency responsive systems only, any of the above types can be supplied for use in frequency systems